

AK130/..-5.0-GREY-BL



A Phoenix Mecano Brand

Technical Data

Wire sizes		Insulating Material	
Solid min	0.14 mm ²	Material	PA 6.6
Solid max	2.5 mm ²	Flammability Class	UL 94 V-0
Stranded (flexible) min	0.14mm ²	Temperatures	
Stranded (flexible) max	1.5 mm ²	Operating Temperature (without mech. load)	-40 °C - 105 °C
Stranded with Ferrule min	0.14 mm ²	Store Temperature	-40 °C - 105 °C
Stranded with Ferrule max	1.5 mm ²	Wave Soldering Process	
Dimensions		Soldering Temperature, recommended	-
Stripped Length	6.0 mm	Peak Soldering Time, recommended	-
Materials		Reflow Process	
Clamp	Brass	Soldering Temperature, recommended	-
Screw	Steel	Peak Soldering Time, recommended	-
Contact Spring	Copper Alloy		

Colours

GREY, RAL 7016

Colours according to RAL, there may be variations on colour due to production conditions. Special colours on request.

Counterparts (Spacing 5.0 mm)

Pin Strip	STL130	STL132	STL140
	In combination of connectors with different admission data, the lower value is valid.		

Order Data (Spacing 5.0 mm)

Poles	Width (mm)	Article Designation	Article Number	PU
2	10.00	AK130/2-5.0-GREY-BL	50130022001 G	250
3	15.00	AK130/3-5.0-GREY-BL	50130032001 G	250
4	20.00	AK130/4-5.0-GREY-BL	50130042001 G	250
5	25.00	AK130/5-5.0-GREY-BL	50130052001 G	250
6	30.00	AK130/6-5.0-GREY-BL	50130062001 G	250
7	35.00	AK130/7-5.0-GREY-BL	50130072001 G	250
8	40.00	AK130/8-5.0-GREY-BL	50130082001 E	100
9	45.00	AK130/9-5.0-GREY-BL	50130092001 E	100
10	50.00	AK130/10-5.0-GREY-BL	50130102001 E	100
11	55.00	AK130/11-5.0-GREY-BL	50130112001 E	100
12	60.00	AK130/12-5.0-GREY-BL	50130122001 E	100
13	65.00	AK130/13-5.0-GREY-BL	50130132001 D	50
14	70.00	AK130/14-5.0-GREY-BL	50130142001 D	50
15	75.00	AK130/15-5.0-GREY-BL	50130152001 D	50
16	80.00	AK130/16-5.0-GREY-BL	50130162001 D	50

Accessoires

Figure	Designation	Article Number
	Bridge, 2-pole, insulated, BRI/2-5.0/5.08-LIGHT GREY	Order Data: 50000000006
	Bridge, 3-pole, insulated, BRI/3-5.0/5.08-LIGHT GREY	Order Data: 50000000007
	Bridge, 2-pole, BR/2-5.0/5.08-L7.0	Order Data: 50000000008

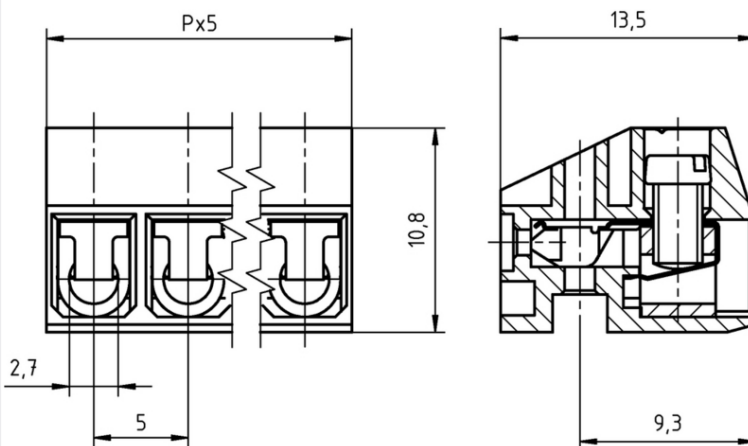

Ratings

UseGroup	cRU [®] US			VDE	
	B	C	D		
Rated Voltage	300 V	150 V	300 V	250 V	
Rated Current	8 A	8 A	8 A	7 A	
Overvoltage Category				III	
Rated Wire Size				min	max
- solid	AWG 22-12	AWG 22-12	AWG 22-12	0.5 mm ² (5 A)	2.5 mm ² (7 A)
- stranded	AWG 22-14	AWG 22-14	AWG 22-14	0.5 mm ² (5 A)	1.5 mm ² (7 A)
Torque	0.45 Nm	0.45 Nm	0.45 Nm	0.40 Nm	
Screw Size	M2.6	M2.6	M2.6	M2.6	
Test Voltage	1.60 kV	1.30 kV	1.60 kV	4.0 kV	
Pollution Degree				3	