



## Technical Data // Series FKB5458 - SMD

Schnittstellenblock 50 mil / 1.27 mm

### HIGHLIGHTS

Interface Pin Block for Center 50 mil

Short, compact size

Board-to-board contacting

Tape on Reel - SMD

2 to 20 poles / 1 and 2 rows available

### MECHANICAL DATA

Center 1.27 mm/50 mil

Full Travel 1.40 mm

Working Travel 0.70 mm

Pre-loaded Spring Force 0.25 N

Spring Force at Working Travel 0.60 N

### ELEKTRISCHE WERTE ELECTRICAL DATA

Max. Current Rating 2.0 A

Typical Continuity Resistance  $\leq 20$  mOhm

### MATERIALS

Barrel Brass, gold-plated

Spring Stainless Steel, gold-plated

Plunger Brass, gold-plated

Test Probe Block PA



# Technical Data // Series FKB5458 - SMD

Schnittstellenblock 50 mil / 1.27 mm

## Soldering profile reflow

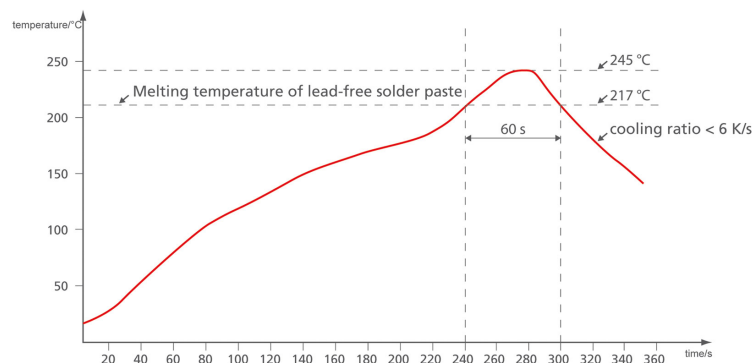

### FKB5458/1

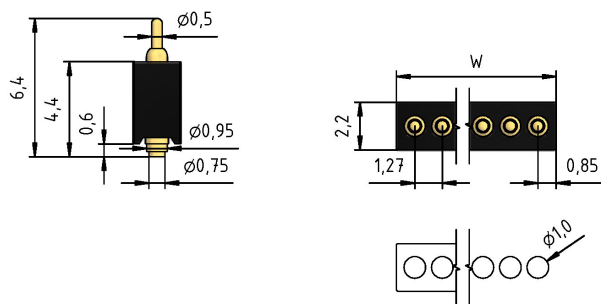

### FKB5458/2

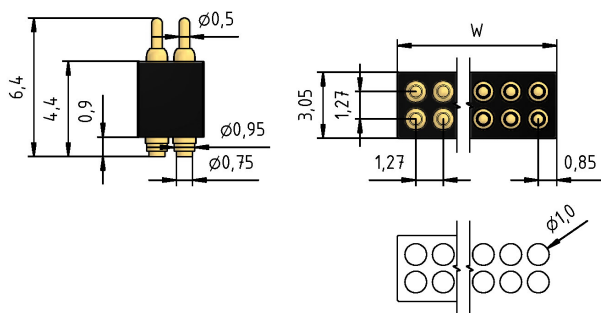

## HOW TO ORDER

**FKB5458 / 1 - 2 - 64**

**1 2 3 4**

- 1. Series 2. Number of Rows 3. Number of Poles
- 4. Installation Height