

AKZ602/..-7.62-V-GREEN





PTR

A Phoenix Mecano Brand

Technical Data

| Wire sizes | | Insulating Material | |
|---------------------------|----------------------|--|-----------------|
| Solid min | 0.14 mm ² | Material | PA 6.6 |
| Solid max | 1.5 mm ² | Flammability Class | UL 94 V-0 |
| Stranded (flexible) min | 0.14mm ² | Temperatures | |
| Stranded (flexible) max | 1.0 mm ² | Operating Temperature (without mech. load) | -40 °C - 105 °C |
| Stranded with Ferrule min | 0.25 mm ² | Store Temperature | -40 °C - 105 °C |
| Stranded with Ferrule max | 0.5 mm ² | Wave Soldering Process | |
| Dimensions | | Soldering Temperature, recommended | 260 °C |
| Stripped Length | 5.0 mm | Peak Soldering Time, recommended | 3-4 s |
| PCB Hole Diameter | 1.1 mm | Reflow Process | |
| Materials | | Soldering Temperature, recommended | - |
| Clamp | Brass | Peak Soldering Time, recommended | - |
| Screw | Bronze | | |
| Solder Tab | Copper Alloy | | |

Colours

| | |
|---|-------------------------------|
|  | GREEN, RAL 6018 |
|  | LIGHT GREEN, similar RAL 6018 |

Colours according to RAL, there may be variations on colour due to production conditions. Special colours on request.

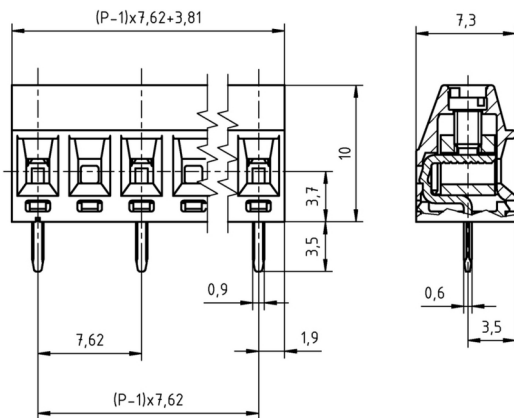

Order Data (Spacing 7.62 mm)

| Poles | Width (mm) | Article Designation | Article Number | PU |
|-------|------------|-----------------------|----------------|-----|
| 2 | 3817.62 | AKZ602/2-7.62-V-GREEN | 50602020061 F | 200 |
| 3 | 3825.24 | AKZ602/3-7.62-V-GREEN | 50602030061 F | 200 |
| 4 | 3832.86 | AKZ602/4-7.62-V-GREEN | 50602040061 E | 100 |
| 5 | 3840.48 | AKZ602/5-7.62-V-GREEN | 50602050061 E | 100 |
| 6 | 3848.10 | AKZ602/6-7.62-V-GREEN | 50602060061 D | 50 |
| 7 | 3855.72 | AKZ602/7-7.62-V-GREEN | 50602070061 D | 50 |
| 8 | 3863.34 | AKZ602/8-7.62-V-GREEN | 50602080061 D | 50 |

Accessoires

| Figure | Designation | Article Number |
|--|---|-------------------------|
|  | Bridge, 2-pole, insulated, BRI/2-7.0/7.62-L7.5-LIGHT GREY | Order Data: 50000000018 |

Ratings

| UseGroup | C _{RU} US | | | VDE | |
|-----------------|--------------------|-----------|-----------|---------------------|---------------------|
| | B | C | D | 750 V | |
| Rated Voltage | 300 V | 150 V | 300 V | 750 V | |
| Rated Current | 10 A | 10 A | - | 13.5 A | |
| Rated Wire Size | | | | min | max |
| - solid | AWG 30-16 | AWG 30-16 | AWG 30-16 | 0.5 mm ² | 1.0 mm ² |
| - stranded | AWG 30-16 | AWG 30-16 | AWG 30-16 | 0.5 mm ² | 1.0 mm ² |
| Torque | 0.25 Nm | 0.25 Nm | 0.25 Nm | 0.20 Nm | |
| Screw Size | M2 | M2 | M2 | M2 | |
| Test Voltage | 1.60 kV | 1.30 kV | 1.60 kV | 3.0 kV | |