



### Technical Data

Wire sizes		Insulating Material	
Solid min	0.2 mm <sup>2</sup>	Material	PA 6.6
Solid max	4.0 mm <sup>2</sup>	Flammability Class	UL 94 V-0
Stranded (flexible) min	0.2mm <sup>2</sup>	<b>Temperatures</b>	
Stranded (flexible) max	2.5 mm <sup>2</sup>	Operating Temperature (without mech. load)	-40 °C - 105 °C
Stranded with Ferrule min	0.25 mm <sup>2</sup>	Store Temperature	-40 °C - 105 °C
Stranded with Ferrule max	2.5 mm <sup>2</sup>	<b>Wave Soldering Process</b>	
<b>Dimensions</b>		Soldering Temperature, recommended	-
Stripped Length	6.0 mm	Peak Soldering Time, recommended	-
<b>Materials</b>		<b>Reflow Process</b>	
Clamp	Brass	Soldering Temperature, recommended	-
Screw	Steel	Peak Soldering Time, recommended	-
Screw, Flange	Steel		
Contact Spring	Bronze		

### Colours

	GREEN, RAL 6018
	LIGHT GREEN, similar RAL 6018

Colours according to RAL, there may be variations on colour due to production conditions. Special colours on request.

### Counterparts (Spacing 10.16 mm)

Pin Strip/Terminal Block

AKZ950	STLZ950	STLZ970
--------	---------	---------

In combination of connectors with different admission data, the lower value is valid.

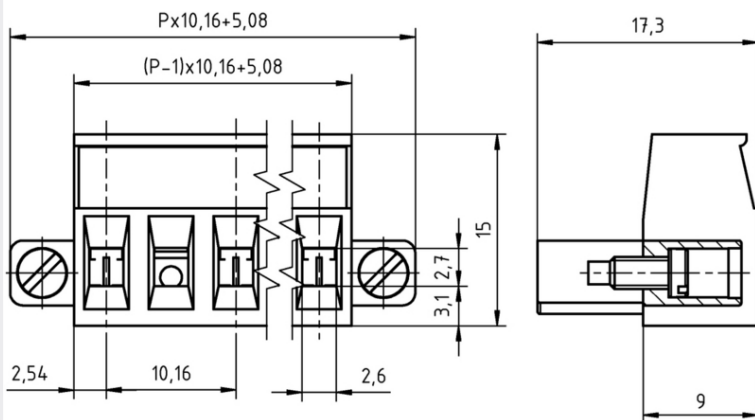

### Order Data (Spacing 10.16 mm)

Poles	Width (mm)	Article Designation	Article Number	PU
2	25.40	AKZ950/2F-10.16-GREEN	50950022061 E	100
3	35.56	AKZ950/3F-10.16-GREEN	50950032061 E	100
4	45.72	AKZ950/4F-10.16-GREEN	50950042061 E	100
5	55.88	AKZ950/5F-10.16-GREEN	50950052061 D	50
6	66.04	AKZ950/6F-10.16-GREEN	50950062061 D	50
7	76.20	AKZ950/7F-10.16-GREEN	50950072061 D	50
8	86.36	AKZ950/8F-10.16-GREEN	50950082061 D	50
9	96.52	AKZ950/9F-10.16-GREEN	50950092061 D	50
10	106.68	AKZ950/10F-10.16-GREEN	50950102061 D	50
11	116.84	AKZ950/11F-10.16-GREEN	50950112061 D	50
12	127.00	AKZ950/12F-10.16-GREEN	50950122061 D	50

### Accessoires

Figure	Designation	Article Number
	Coding Star CS1-5.0/5.08-RED	Order Data: 50000000021
	Series AK(Z)950 with Separating Element	Order Data: on request
	Series AK(Z)950 with pull relief	Order Data: on request

### Ratings

UseGroup	cULus			VDE	
	B	C	D		
Rated Voltage	300 V	150 V	300 V	630 V	
Rated Current	15 A	15 A	-	12 A	
Overtoltage Category				III	
Rated Wire Size				min	max
- solid	AWG 22-12	AWG 22-12	AWG 22-12	0.5 mm <sup>2</sup> (5 A)	2.5 mm <sup>2</sup> (12 A)
- stranded	AWG 22-12	AWG 22-12	AWG 22-12	0.5 mm <sup>2</sup> (5 A)	2.5 mm <sup>2</sup> (12 A)
Torque	0.50 Nm	0.50 Nm	0.50 Nm	0.50 Nm	
Screw Size	M3	M3	M3	M3	
Test Voltage	1.60 kV	1.30 kV	1.60 kV	6.0 kV	
Pollution Degree				3	