

STL950/..G-5.0-H-GREEN



A Phoenix Mecano Brand

Technical Data

| Wire sizes | | Insulating Material | |
|---------------------------|--------------|--|-----------------|
| Solid min | - | Material | PA 6.6 |
| Solid max | - | Flammability Class | UL 94 V-0 |
| Stranded (flexible) min | - | Temperatures | |
| Stranded (flexible) max | - | Operating Temperature (without mech. load) | -40 °C - 105 °C |
| Stranded with Ferrule min | - | Store Temperature | -40 °C - 105 °C |
| Stranded with Ferrule max | - | Wave Soldering Process | |
| Dimensions | | Soldering Temperature, recommended | 260 °C |
| PCB Hole Diameter | 1.4 mm | Peak Soldering Time, recommended | 3-4 s |
| Materials | | Reflow Process | |
| Contact Pin | Copper Alloy | Soldering Temperature, recommended | - |
| | | Peak Soldering Time, recommended | - |

Colours

| | |
|--|-------------------------------|
| | GREEN, RAL 6018 |
| | BLACK, RAL 9011 |
| | BASALT GREY, RAL 7012 |
| | PEBBLE GREY, RAL 7032 |
| | LIGHT GREY, RAL 7035 |
| | LIGHT GREEN, similar RAL 6018 |

Colours according to RAL, there may be variations on colour due to production conditions. Special colours on request.

Counterparts (Spacing 5.0 mm)

| Terminal Block | | | | | |
|----------------|-------|--------|--------|--------|--------|
| AK950 | AK955 | AK1100 | AK1110 | AK1200 | AK3950 |

In combination of connectors with different admission data, the lower value is valid.

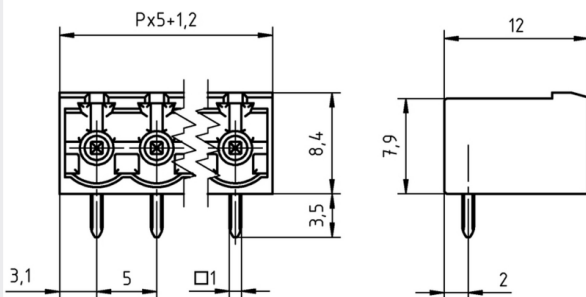

Order Data (Spacing 5.0 mm)

| Poles | Width (mm) | Article Designation | Article Number | PU |
|-------|------------|------------------------|----------------|-----|
| 2 | 11.20 | STL950/2G-5.0-H-GREEN | 50950025001 F | 200 |
| 3 | 16.20 | STL950/3G-5.0-H-GREEN | 50950035001 F | 200 |
| 4 | 21.20 | STL950/4G-5.0-H-GREEN | 50950045001 F | 200 |
| 5 | 26.20 | STL950/5G-5.0-H-GREEN | 50950055001 E | 100 |
| 6 | 31.20 | STL950/6G-5.0-H-GREEN | 50950065001 E | 100 |
| 7 | 36.20 | STL950/7G-5.0-H-GREEN | 50950075001 E | 100 |
| 8 | 41.20 | STL950/8G-5.0-H-GREEN | 50950085001 D | 50 |
| 9 | 46.20 | STL950/9G-5.0-H-GREEN | 50950095001 D | 50 |
| 10 | 51.20 | STL950/10G-5.0-H-GREEN | 50950105001 D | 50 |
| 11 | 56.20 | STL950/11G-5.0-H-GREEN | 50950115001 D | 50 |
| 12 | 61.20 | STL950/12G-5.0-H-GREEN | 50950125001 D | 50 |
| 13 | 66.20 | STL950/13G-5.0-H-GREEN | 50950135001 D | 50 |
| 14 | 71.20 | STL950/14G-5.0-H-GREEN | 50950145001 D | 50 |
| 15 | 76.20 | STL950/15G-5.0-H-GREEN | 50950155001 D | 50 |
| 16 | 81.20 | STL950/16G-5.0-H-GREEN | 50950165001 D | 50 |
| 17 | 86.20 | STL950/17G-5.0-H-GREEN | 50950175001 D | 50 |
| 18 | 91.20 | STL950/18G-5.0-H-GREEN | 50950185001 D | 50 |
| 19 | 96.20 | STL950/19G-5.0-H-GREEN | 50950195001 D | 50 |
| 20 | 101.20 | STL950/20G-5.0-H-GREEN | 50950205001 D | 50 |
| 21 | 106.20 | STL950/21G-5.0-H-GREEN | 50950215001 D | 50 |
| 22 | 111.20 | STL950/22G-5.0-H-GREEN | 50950225001 D | 50 |
| 23 | 116.20 | STL950/23G-5.0-H-GREEN | 50950235001 D | 50 |
| 24 | 121.20 | STL950/24G-5.0-H-GREEN | 50950245001 D | 50 |

Accessoires

| Figure | Designation | Article Number |
|--------|------------------------------------|-------------------------|
| | Coding Star CS2-5.0/5.08-RED | Order Data: 50000000024 |
| | Separating Element SE-STL950-GREEN | Order Data: 50950000002 |

Ratings

| UseGroup | cULUS | | | VDE |
|----------------------|---------|---------|---------|--------|
| | B | C | D | |
| Rated Voltage | 300 V | 150 V | 300 V | 250 V |
| Rated Current | 15 A | 15 A | 10 A | 12 A |
| Overvoltage Category | | | | III |
| Test Voltage | 1.60 kV | 1.30 kV | 1.60 kV | 4.0 kV |
| Pollution Degree | | | | 3 |